

MAYFAIR PERFORMANCE

PART NO.
137-8580

TITLE:
MECHANICAL HEADS UP INDICATOR - STEP 1

www.mayfairperformance.com

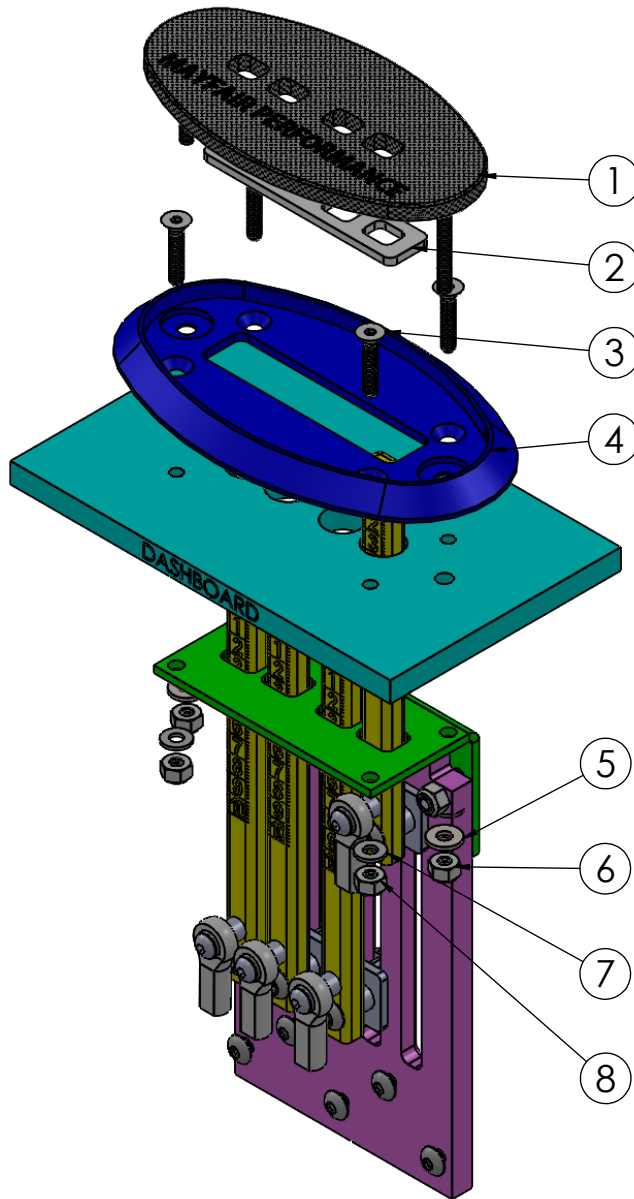

INSTALLATION INSTRUCTONS:

- 1) BEFORE DRILLING, CHECK FOR INSTALLATION INTERFERENCE. DRILL DASHBOARD USING THE SUPPLIED DRILL TEMPLATE. DASHBOARD SHOWN IS 3/8 THICK. CAN BE USED UP TO 1/2 THICK.
- 2) THIS COMES PREASSEMBLED AS SHOWN IN BOTH FRONT AND BACK VIEWS.
- 3) REMOVE #1 CARBON FACE PLATE, #2 STICK GUIDE, #3 BOLTS AND #4 BEZEL.
- 4) SLIDE ASSEMBLY UP THROUGH THE DASH.
- 5) APPLY ANTI-SIEZE TO BOLTS AND STUDS.
- 6) INSTALL #4 BEZEL USING THE #4 #10-24x1.00 BOLTS, #5 WASHERS & #6 NUTS. USING 1/8 ALLEN KEY AND 3/8 SOCKET, SNUG BOLTS.
- 7) SLIDE #2 GUIDE OVER THE STICKS AND INTO THE CUTOUT IN THE BEZEL. MAKE SURE STICKS SLIDE FREELY.
- 8) NOW, TORQUE #4 BOLTS TO 80 IN. LBS..
- 9) SLIDE #1 CARBON FACE OVER THE STICK. USE A 3/8 SOCKET TO TORQUE THE #7 WASHERS AND #8 NUTS TO 40 IN. LBS..
- 10) USING A 1/8 ALLEN SOCKET LOOSEN #9 SCREWS. WITH THE STICK ALL THE WAY UP. ADJUST BRACKET SO LINE 10 ON THE STICK IS EVEN WITH THE CARBON FACE BEZEL, SEE DETAIL A. TORQUE BOLTS TO 40 IN. LBS..

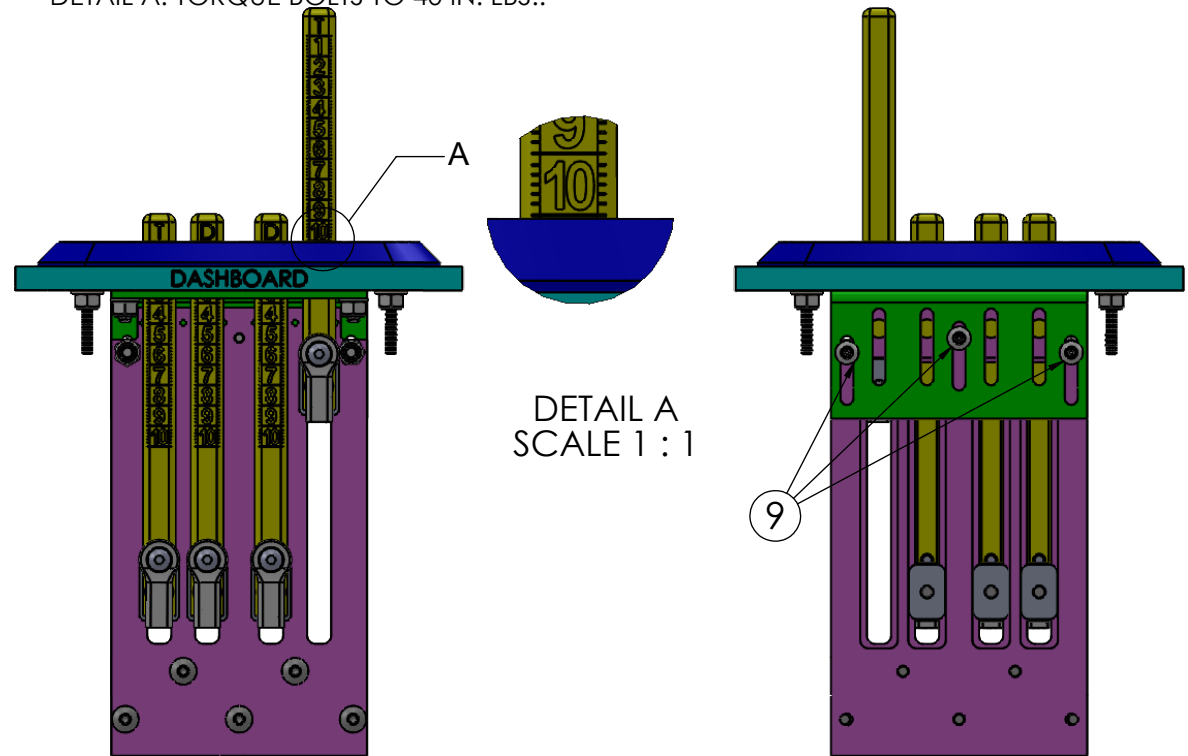

FRONT VIEW

BACK VIEW

THIS DRAWING IS CONFIDENTIAL AND IS SUPPLIED ON EXPRESS CONDITION THAT IT SHALL NOT BE LENT, COPIED OR DISCLOSED TO ANY OTHER PERSON OR USED FOR ANY OTHER PURPOSE WITHOUT WRITTEN CONSENT OF MAYFAIR PERFORMANCE. BREACH OF THIS CONTRACT WILL HOLD AND IT'S PRINCIPALS LIABLE FOR LOSS AND DAMAGES.

MAYFAIR PERFORMANCE

PART NO.
137-8580

TITLE:
MECHANICAL HEADS UP INDICATOR - STEP 2

www.mayfairperformance.com

INSTALLATION INSTRUCTIONS:

- 1) APPLY RED LOCTITE TO #1 SCREWS. USING 1/8 ALLEN SOCKET, INSTALL #2 BRACKET USING #1 SCREWS. TORQUE TO 80 IN. LBS..
- 2) REMOVE CABLE JAM NUT, FIG. A. SLIDE #11 SPRING, #10 CUP AND #9 OVER CABLE, AS SHOWN.
- 3) APPLY ANTI-SIEZE TO CABLE THREADS. INSTALL CABLE JAM NUT AND #7 ROD END TILL THE THREAD BOTTOMS OUT..
- 4) USING 1/8 ALLEN SOCKET & #8 SCREW. INSTALL ROD END TO THE STICK. MAKE SURE TO POSITION #6 SPACER BETWEEN THE ROD END AND THE STICK, AS SHOWN.
- 5) ADJUST CABLES.
- 6) AFTER ADJUSTING CABLE. REMOVE #8 SCREW. APPLY BLUE LOCTITE AND TORQUE TO 40 INCH LBS.
- 7) APPLY ANTI-SIEZE TO #3 BOLTS. USING 1/8 HEX SOCKET AND 3/8 SOCKET. ATTACH CABLE BRACE TO THE BOTTOM SIDE OF THE BRACKET. INSTALL #5 NUTS. TORQUE TO 80 IN. LBS..

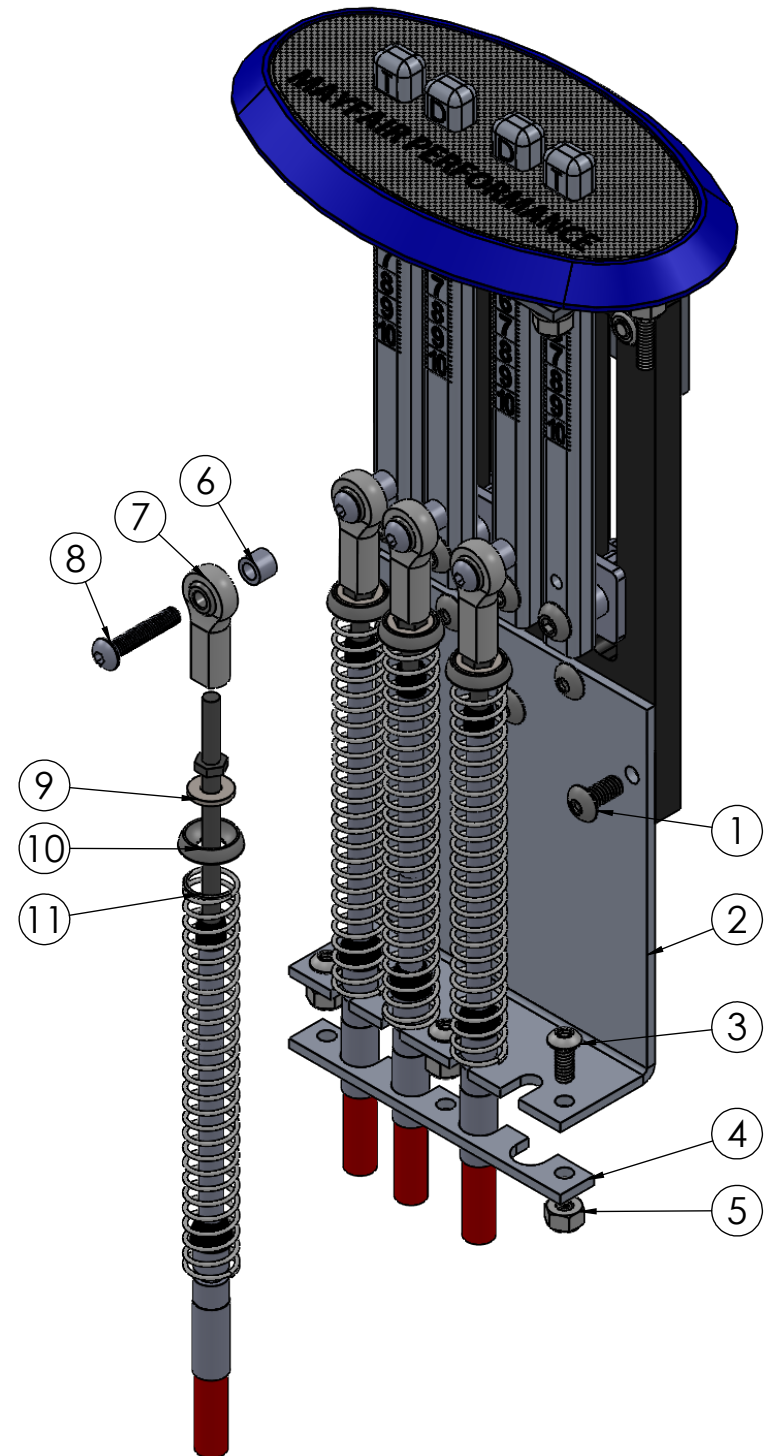

THIS DRAWING IS CONFIDENTIAL AND IS SUPPLIED ON EXPRESS CONDITION THAT IT SHALL NOT BE LENT, COPIED OR DISCLOSED TO ANY OTHER PERSON OR USED FOR ANY OTHER PURPOSE WITHOUT WRITTEN CONSENT OF MAYFAIR PERFORMANCE. BREACH OF THIS CONTRACT WILL HOLD AND IT'S PRINCIPALS LIABLE FOR LOSS AND DAMAGES.

MAYFAIR PERFORMANCE

PART NO.
137-8583

TITLE:
MECHANICAL HEADS UP INDICATOR DIMENSIONS

www.mayfairperformance.com

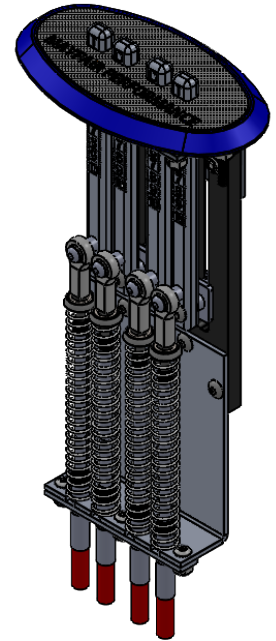
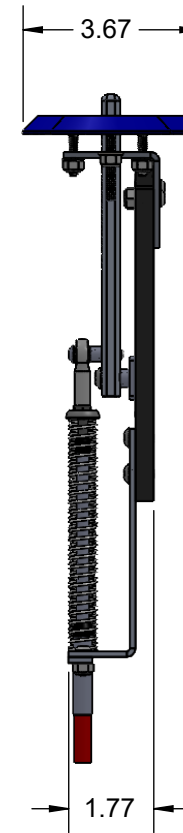
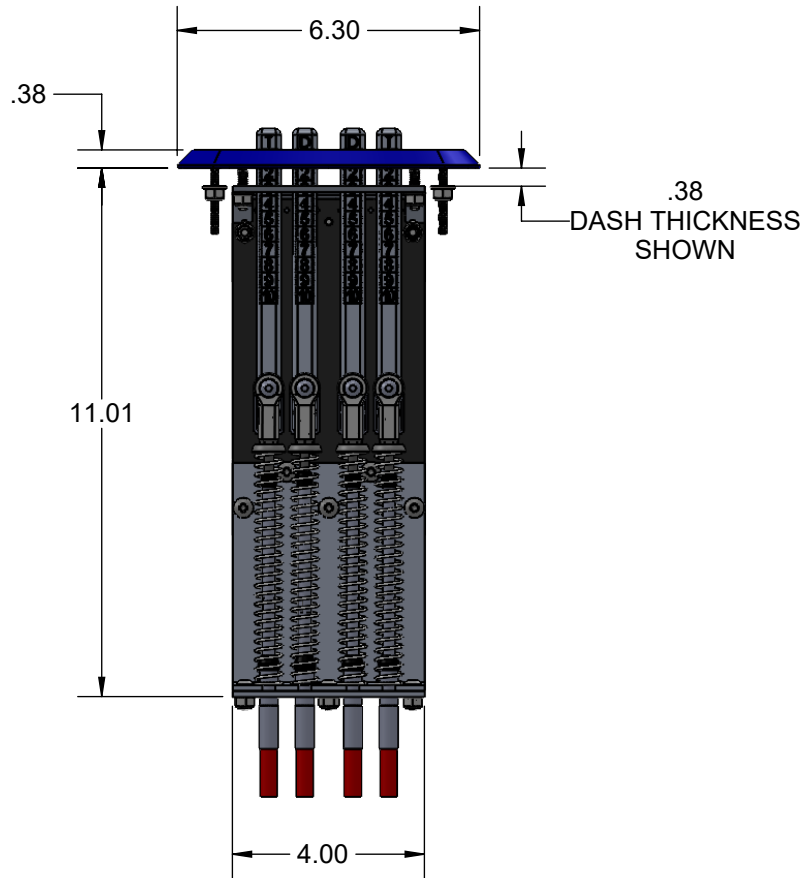

THIS DRAWING IS CONFIDENTIAL AND IS SUPPLIED ON EXPRESS CONDITION THAT IT SHALL NOT BE LENT, COPIED OR DISCLOSED TO ANY OTHER PERSON OR USED FOR ANY OTHER PURPOSE WITHOUT WRITTEN CONSENT OF MAYFAIR PERFORMANCE INC.. BREACH OF THIS CONTRACT WILL HOLD AND IT'S PRINCIPALS LIABLE FOR LOSS AND DAMAGES.

MAYFAIR PERFORMANCE

PART NO.
137-8599

TITLE: HEADS UP INDICATOR DRILL TEMPLATE

www.mayfairperformance.com

MAKE SURE THE PRINTER IS SET TO PRINT AT 100%
SCALE. CHECK MEASUREMENT OF THE LINE BELOW.

INSTRUCTIONS:

- 1) CUT ALONG THE BLUE LINE. THAT IS THE OUTSIDE PROFILE OF THE BEZEL. TAPE TO THE DASH.
- 2) CENTER PUNCH ALL 6 OF THE SMALL HOLES.
- 3) DEPENDING HOW MANY STICKS YOU ARE INSTALLING CENTER MARK THOSE HOLES.
- 4) DRILL EACH HOLE ACCORDING TO SIZE.

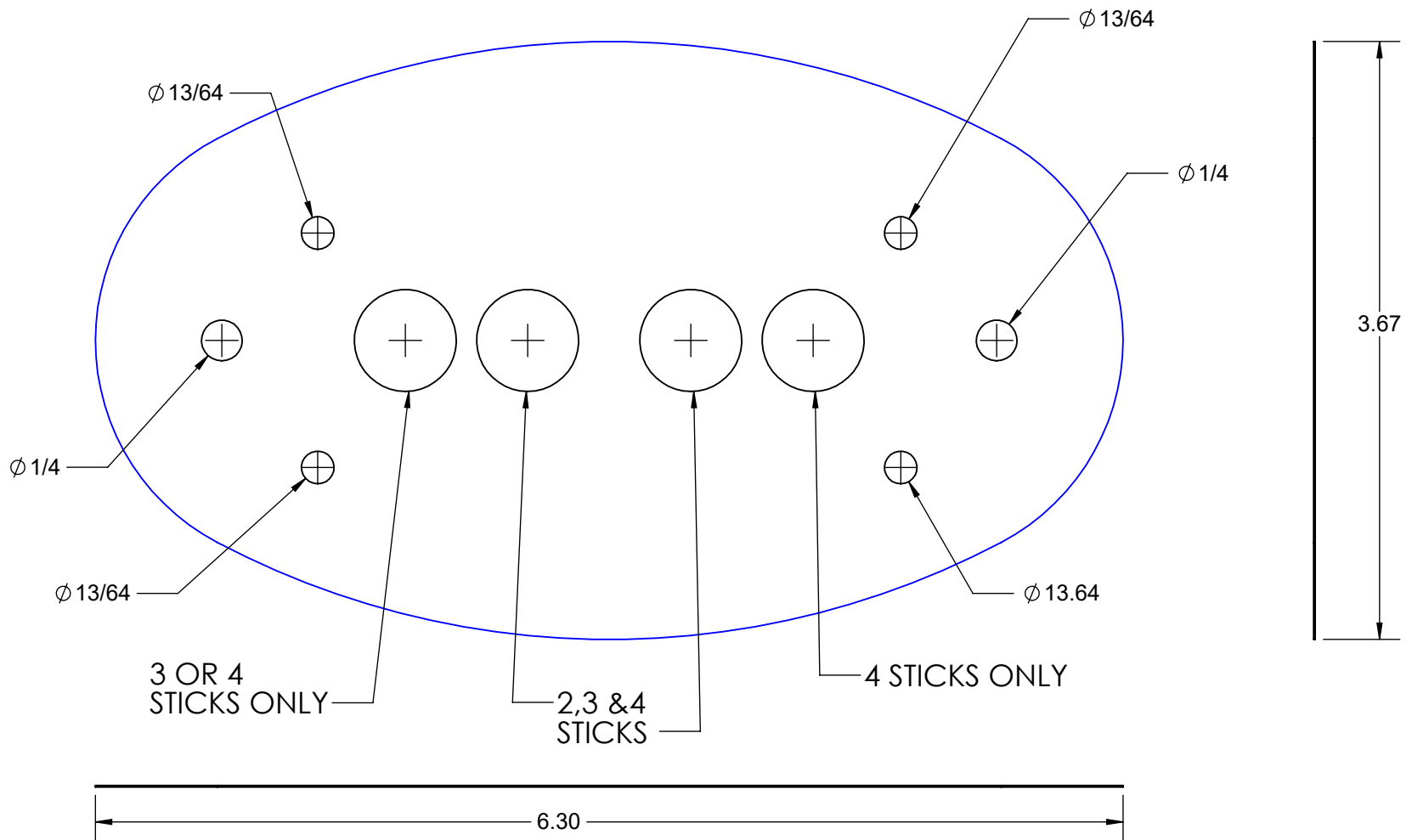
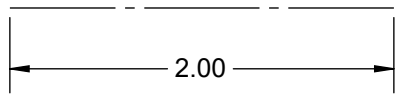

THIS DRAWING IS CONFIDENTIAL AND IS SUPPLIED ON EXPRESS CONDITION THAT IT SHALL NOT BE LENT, COPIED OR DISCLOSED TO ANY OTHER PERSON OR USED FOR ANY OTHER PURPOSE WITHOUT WRITTEN CONSENT OF MAYFAIR HYDRAULICS INC.. BREACH OF THIS CONTRACT WILL HOLD AND IT'S PRINCIPALS LIABLE FOR LOSS AND DAMAGES.